



*Patent Guy Royer*

The FOBLIGHT anchor is supplied dismantled with it's own "easy to carry" stowage bag.

# FOB LIGHT

*The efficient light weight anchor that makes mooring a pleasure*

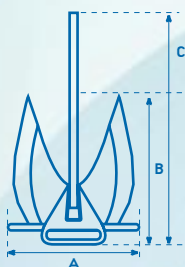

### Dimensions cm

FOBLIGHT	A	B	C
E 6	30	35	57
E 10	36	39	65
E 14	43	48	70
E 20	43	50	78



**FOB SAS**

P.O. Box 14  
29801 Brest Cedex 09  
France

Phone: +33 2 98 02 04 17  
Fax: +33 2 98 02 43 48



# FOBLIGHT

*The efficient design makes this light weight anchor a joy to use*

Effective ground penetration for sea anchors relates more to design geometry than weight.

The FOBLIGHT is up to three times lighter than traditional anchors with similar holding power.



## Ideal for

- Easy mooring when used with leaded rope.
- Frequent mooring is less strenuous.



Support for FOBLIGHT anchor

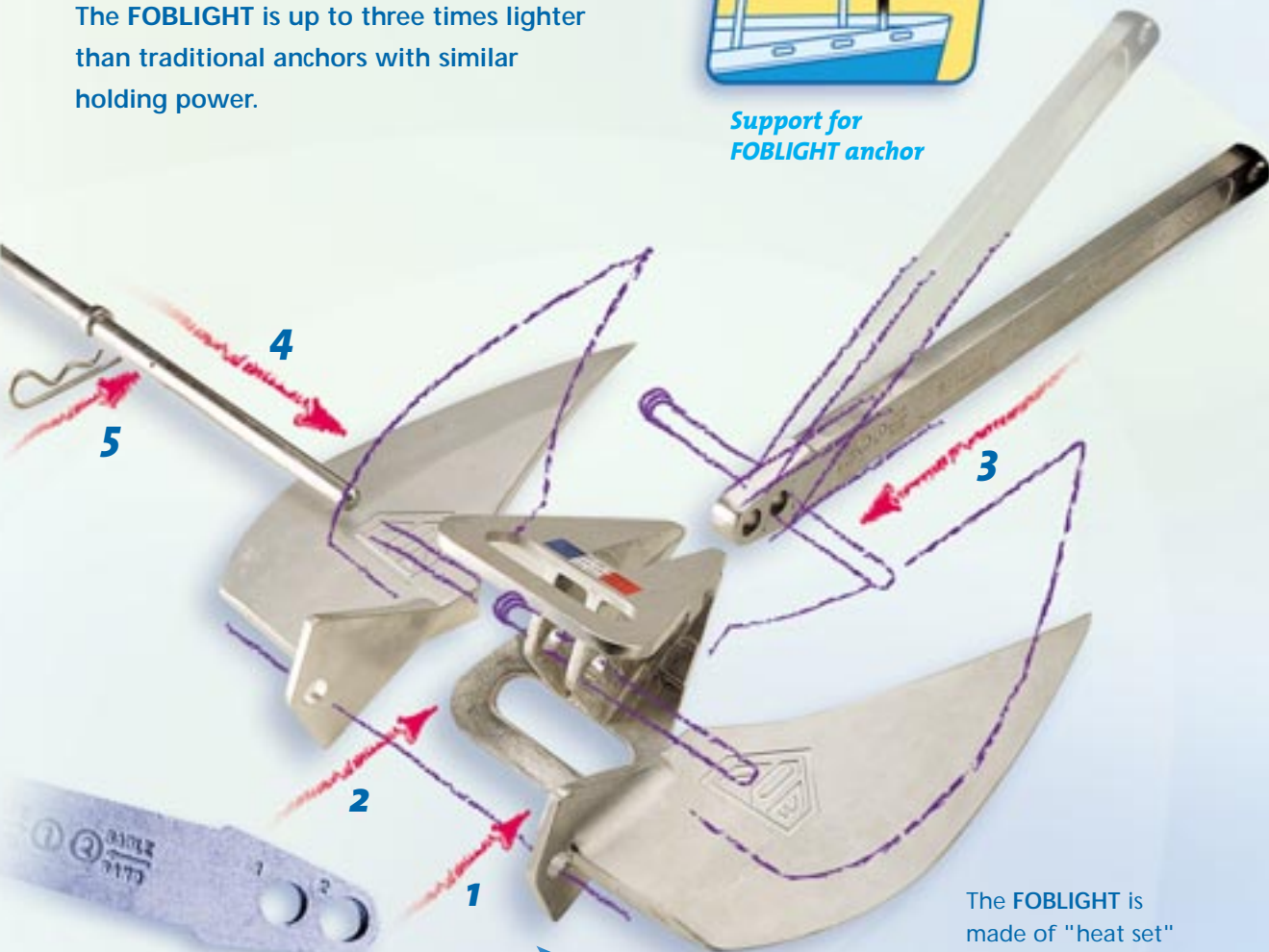

Blades adjustable for best performance in different types of seabed.



The FOBLIGHT is made of "heat set" aluminium, magnesium and titanium, alloy giving it strength equivalent to steel.

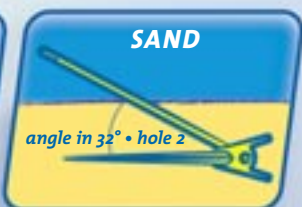
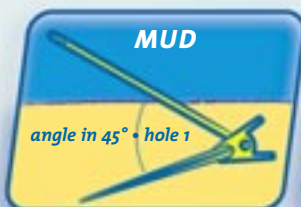

Equivalent anchors steel	Anchor weight	Boat displacement	Diameter of the leaded rope
E 6 kg*	2,0 kg	P < 2,5 T	8 mm
E 10 kg	3,9 kg	2,5 T < P < 4,5 T	10 mm
E 14 kg	5,8 kg	4,5 T < P < 7 T	12 mm
E 20 kg	7,6 kg	7 T < P < 12 T	14 mm

\* 3 elements